

BATTERY

The programmer is fitted with a non-rechargeable, long life battery, which will maintain the programmed time settings for a minimum of ten months with the supply disconnected. THIS SHOULD BE SUFFICIENT TO COVER POWER INTERRUPTIONS DURING THE LIFE OF THE UNIT. During power interruptions the display will be blank, after 3 days the current time of day will be lost. These measures are to prolong the battery life.

SERVICE AND REPAIR

This programmer is NOT user serviceable. Please do not dismantle the unit. In the unlikely event of a fault developing please refer to the RESETTING THE PROGRAMMER section of this user guide located on page 2. If this fails to resolve the problem please contact a local heating engineer or a qualified electrician.

QUESTIONS AND ANSWERS

The unit display has become frozen	This could be due to local electrical interference Using the RESET procedure may rectify the fault.
The indicator neon fails to illuminate on Hot water or Central heating channel	Using the RESET procedure may rectify the fault. If the problem persists the programmer will need replacing.
The indicator neon will illuminate but the pump and/or boiler fails to operate	This may indicate a problem elsewhere in your system; E.g. A zone valve, etc. please contact a registered installer for advice.
There is no display on the programmer	Try the RESET procedure on page 2, if this fails to rectify the problem please have the mains supply checked
How do I know if the programmer is still under warranty	The CentaurPlus range comes with a 2 year guarantee from the date of manufacture. This date is located on the rear of the unit, indicated by a month over a year
How is the programmer removed from the wall	WARNING: The CentaurPlus programmer must only be removed from it's backplate by either a qualified electrician or heating engineer; The programmer plugs in to a 6 pin backplate located on the rear of the unit and is secured using 2 screws located on the bottom surface of the unit. Undo these screws and pull forward and up in an arc motion

Horstmann Controls Limited
Bristol
BS4 1UP

Email: sales@horstmann.co.uk
Website: www.horstmann.co.uk



LEAFLET No P60497
ISSUE 4

CENTAURPLUS C21
USER INSTRUCTIONS



HORSTMANN

Horstmann's CentaurPlus - Two Channel Programmers Offer up to three programmed operating periods per day with Hot water Boost and Heating Advance control on a fully pumped system.

The following are some of the easy to operate features:-

1 Hour Boost on Hot Water
Independent timing on Hot Water and Heating
Central Heating Advance gives instant On/Off override
Up to 3 On/Off periods per channel in each 24Hr operation.
Programme options: Auto / All day / 24 Hours / Off

FRONT VIEW OF PROGRAMMER

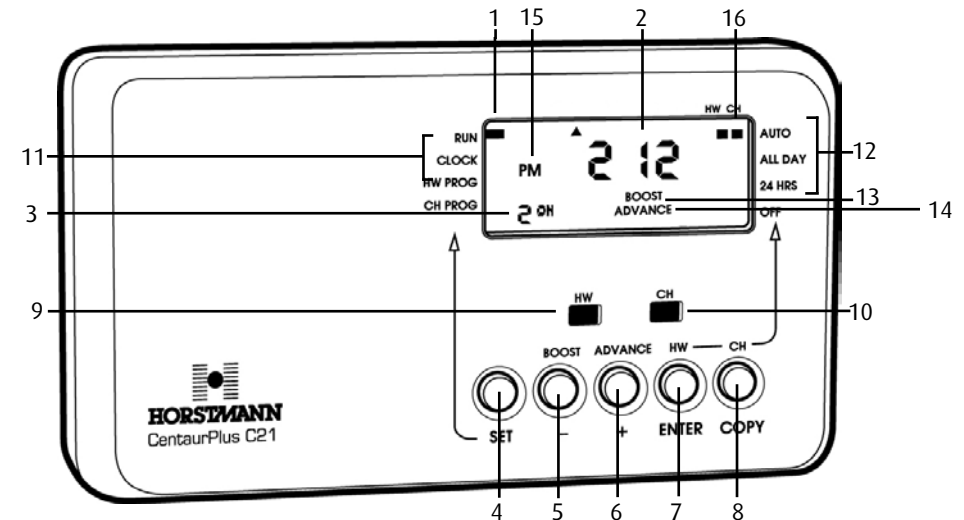

- 1.SET indicator
- 2.Time of day
- 3.Switch Period symbol
- 4.SET Button
- 5.Hot water BOOST or adjust (-) button
- 6.Central heating ADVANCE or adjust (+) button
- 7.Hot water (HW) select or ENTER Button
- 8.Central heating (CH) select button
- 9.Hot water ON indicator
- 10.Central heating ON indicator
- 11.SET positions
- 12.PROGRAMME positions
- 13.BOOST symbol
- 14.ADVANCE symbol
- 15.AM/PM symbol
- 16.PROGRAMME indicators

RESETTING THE PROGRAMMER

Electronic equipment can in some circumstances be affected by electrical interference. If the programmer's display becomes frozen or scrambled; or if you wish to revert back to the default time settings please use the following procedure.

Press the SET and CH buttons together then release the buttons and the programmer will return to preset factory settings.

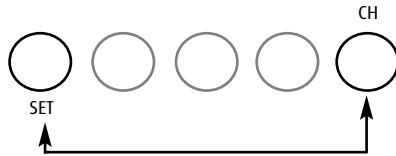

The simple instructions below are designed to help with the programming of the unit.

SETTING THE TIME OF DAY

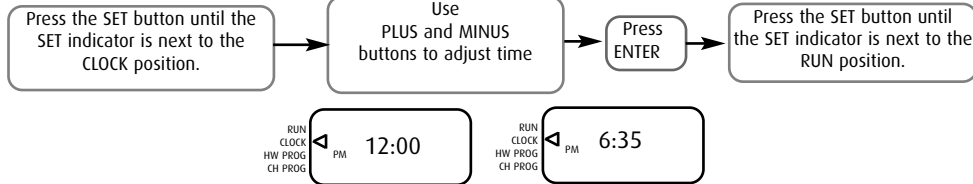

DEFAULT TIME SETTINGS

1st ON	1st OFF	2nd ON	2nd OFF	3rd ON	3rd OFF
6:30 AM	8:30 AM	12:00 PM	12:00 PM	4:30 PM	10:30 PM

The default factory settings are shown above, however if you wish to change these proceed as instructed below.

SETTING THE ON AND OFF TIMES

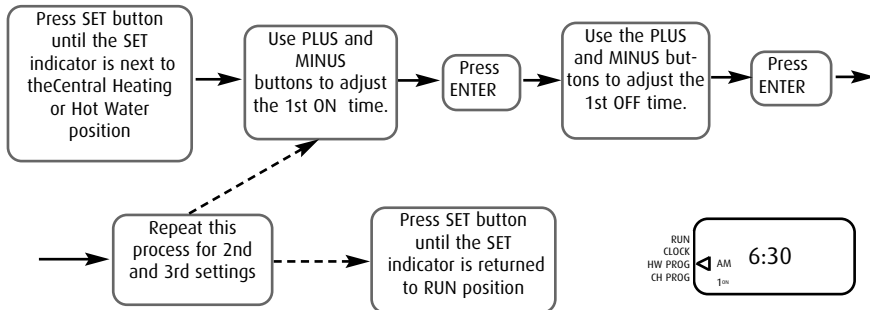

Should you encounter any problems, please refer to the **Question and Answer** section located on page 4.

INFORMATION AND ADVICE

Programming ON/OFF times

If a Heating or Hot water period is not required it can be cancelled by setting the ON and OFF settings to the same time. Example ON 10:00am OFF 10:00am

SPECIAL FEATURES

The SET indicator must remain in the RUN position for the following instructions. The following actions work independently on either Hot Water or Central Heating.

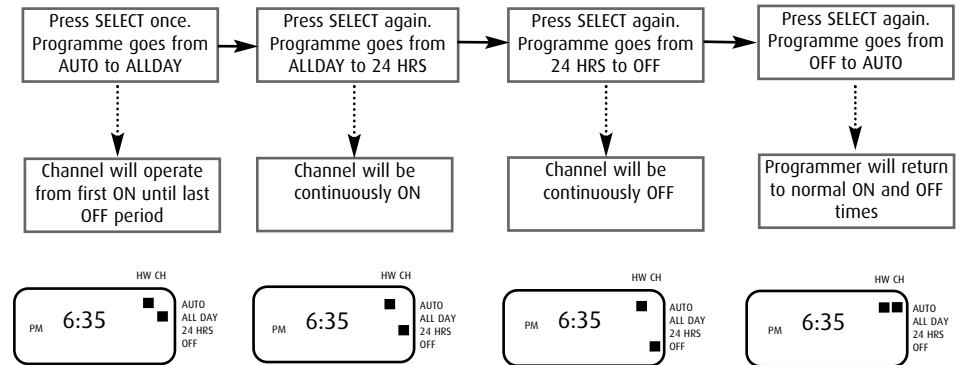

BOOST FUNCTION - 1hour temporary override

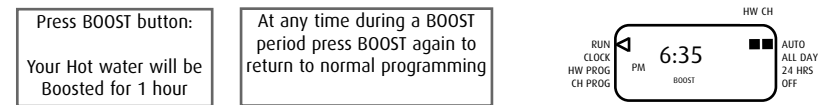

ADVANCE FUNCTION - Brings forward next ON or OFF operation

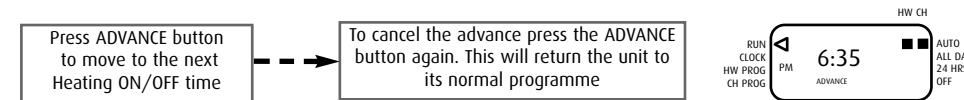

FULLY PUMPED OR GRAVITY SYSTEM

The installer will have set the programmer to suit the installed system. If this is a Fully pumped system this will allow independent control of the Central heating and Hot water, however on a Gravity system the Central heating and Hot water are linked so that it is not possible to use the Central heating independently. This will allow only one common time setting for both Hot Water and Central Heating.